

**INSET "F"**  
 20 UNITS TOTAL  
 VILLAGE PARK CONDOMINIUMS  
 BLOCK 33 LOT 12  
 234 MAITLAND AVENUE  
 TAX SHEET 5

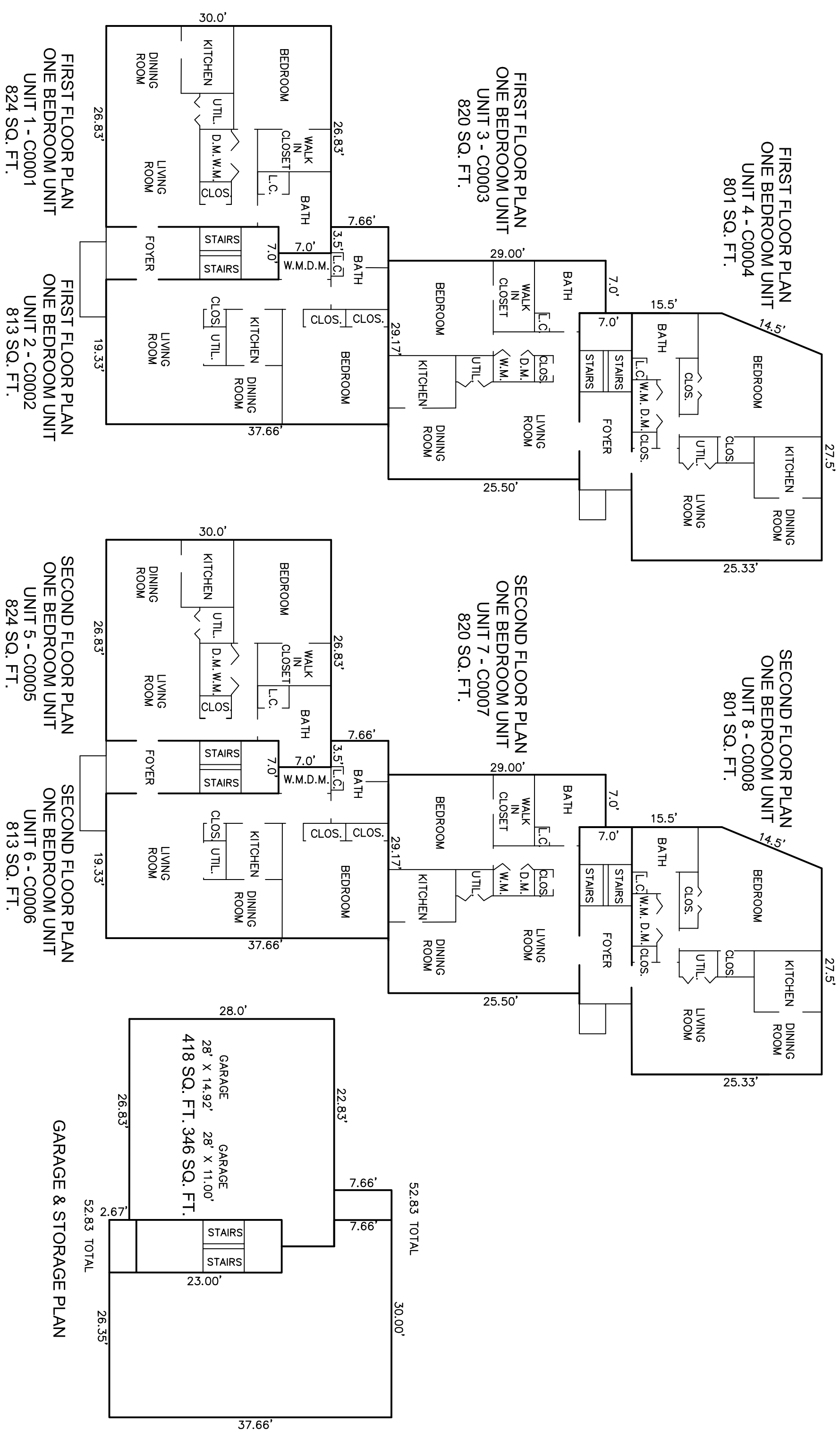

**INSET "E"**  
 8 UNITS TOTAL  
 WASHINGTON POINTE CONDOMINIUMS  
 BLOCK 33 LOT 2  
 24 GRAND AVENUE  
 TAX SHEET 5

THIS MAP HAS BEEN DRAWN USING COMPUTER AIDED  
 DRAFTING/DESIGN (CAD/D).

**TAX MAP**  
 BOROUGH OF HAWTHORNE  
 PASSAIC COUNTY, NEW JERSEY  
 SCALE: 1"=200'  
 FEBRUARY 2017  
**FRANK M. KRUPINSKI, P.L.S.**  
 BOSWELL McCLAVE ENGINEERING  
 330 PHILLIPS AVENUE  
 SOUTH HACKENSACK, N.J. 07606